

DUNE ROAD

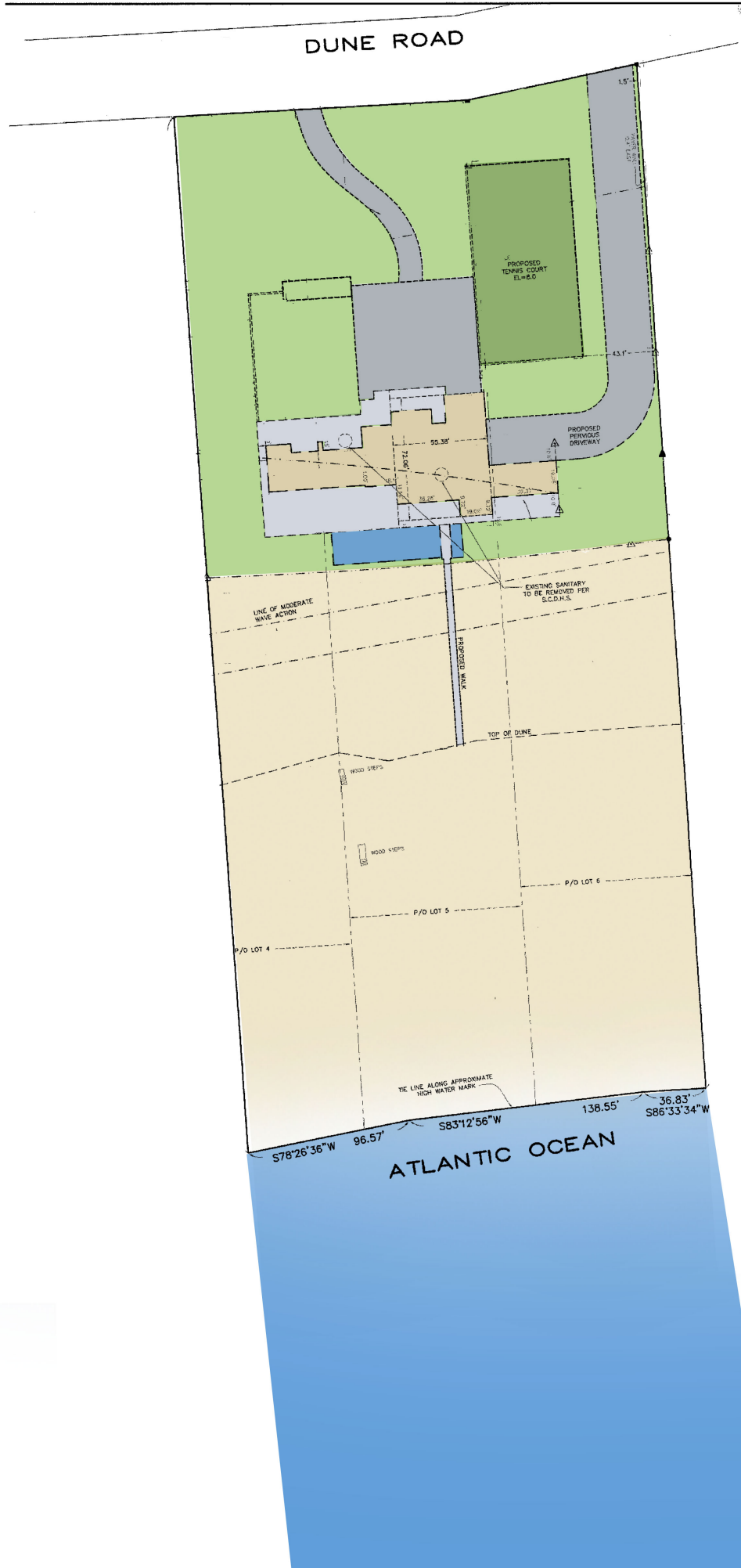

LINE OF MODERATE WAVE ACTION

EXISTING SANITARY TO BE REMOVED PER S.C.D.H.S.

TOP OF DUNE

WOOD STEPS

WOOD STEPS

P/O LOT 4

P/O LOT 5

P/O LOT 6

THE LINE ALONG APPROXIMATE HIGH WATER MARK

S78°26'36"W 96.57'

S83°12'56"W 138.55'

S86°33'34"W 36.83'

ATLANTIC OCEAN